

**RL-330****Roll laminator
Pouch laminator****Hot roller
Technology****Digital
Display****1" and 3" roll
Applicable****Start & Stop
Function****Multiple
Functions****Auto
Shutoff**

This compact easy to set-up and operate laminator has low cost but multi-functions, it can run roll laminates up to 125mic thick as well as pouch laminate up to 175mic thick. The LED control panel shows working conditions and fault alerts. The roller lifter can lift up the top roller for easy film threading. The optional Start and Stop function enable automatic stop when there is no paper feed, thus the operator will not worry about wasting film. The extension arm enable 1" and 3" roll film applicable. The auto shutoff function stop heating after 2 hours without working. The compact design either save huge shipping cost or make it occupy a small working place. It is ideal for schools, office and professionals with on-demand lamination needs.

Features

Hot roller technology

Can laminate both roll film and pouch film

32-bit CPU controlled PCB

LED display shows working conditions

Safety cover conform to safety regulations

Auto shutoff after 120 minutes without working

Optional Start and Stop function

Synchronized gear system enable best pouch lamination

Extended film mandrel enable 1" and 3" core roll





Digital control panel

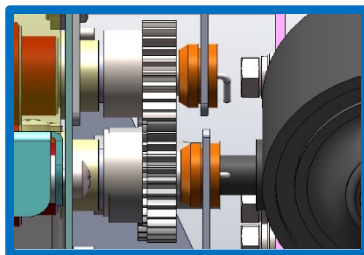

Synchronized gear system



New tension adjustment

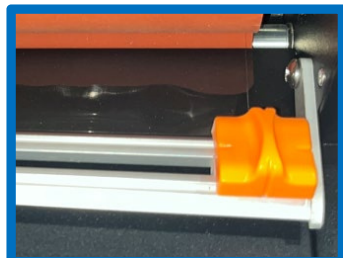

Optional back trimmer



Extended film mandrel

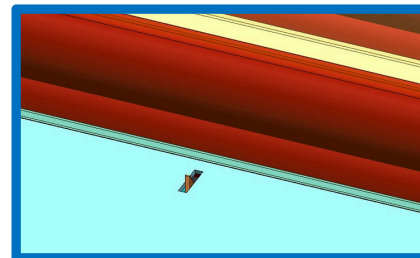

Optional Start & Stop

Specifications

| Model | RL-330 | RL-460 |
|-----------------------------|-----------------------------------------------------|-----------------------------------------------------|
| Max. laminating width | 330mm | 460mm |
| Max Film Thickness | Roll film: 125 mic; Pouch film: 175mic | |
| Laminating speed | 9 speed levels, adjustable up to 1.5m/min | |
| Max. laminating temperature | Adjustable up to 140 °C | |
| Control system | 32-bit CPU control PCB, LCD display | |
| Heating system | Infrared Heater / Hot silicon roller | |
| Top roller lifting height | About 5mm | About 5mm |
| Roller sizes | Heating rollers: Ø 25mm; Pulling rollers: Ø 25mm | Heating rollers: Ø 25mm; Pulling rollers: Ø 25mm |
| Safety shield | Yes | |
| Feeding table | Yes, with paper guide | |
| ECO mode | Yes, drop to 80°C after 60 min. without working | |
| Auto Shutoff | Yes, after 120 min. without working | |
| Key lock | Optional | |
| Cross trimmer | Optional | |
| Film Core Size | 1" standard, optional 2.25" or 3" | |
| Power Capacity | 850W | 1100W |
| Electrical Requirements | AC 110-240V; 50/60Hz | |
| Machine Dimensions (LxWxH) | 560x340x307mm | 690x340x307mm |
| Weight | 18 Kgs | 25 kgs |